



Cable Switches Accessories

Cable RL 5

Cable RL 3



Drum with a cable RL5,
the length of 500 m
Drum with a cable RL3,
the length of 500 m

Eye on the cable



SKA3

SKA5



Spring SPF-W with a chain



**Pulley
URL5**

Cable clamp



SKL5



SKL3

Type	Description
RL5	Cable, the diameter of 5 mm, galvanized steel with red PVC coating
RL3	Cable, the diameter of 3 mm, galvanized steel with red PVC coating
SPS6	Tension lock
SKA5	Eye on the cable of 5 mm
SKA3	Eye on the cable of 3 mm
SKL5	Cable clamp 5 mm
SKL3	Cable clamp 3 mm
SH...	Cable guiding eye for precise guiding and support to the cable (do not exceed the maximum span of 5 m), delivered in various diameters and as an open or closed type
SPF-W	Spring with a chain, stainless steel
M25x1,5	Bushing M25 x 1.5 Ip68 for a series of LHP... switches
M20x1,5	Bushing M20 x 1.5 Ip68 for a series of SNS... switches
...-VA	Suffix VA means the accessories made of stainless steel to be used in an aggressive environment. Example: RL5-VA cable, the diameter of 5 mm, stainless steel, with red PVC coating

**M6 nut,
right thread**



**M6 nut,
left thread**

Tension lock SPS 6

The catalogue has only those selected important parameters for your final decision. For project designs always ask for the user's guide for this product and any engineering consultation about possible uses.



Cable Switches Accessories



SH1

SH3

SH6



SH0

SH5

SH2

Dimension table of closed guiding eyes

Typ	d	L	L1	D
SH0	M6	80	55	10
SH2	M10	130	85	14
SH4	M8	90	55	23
SH5	M12	100	55	17

Dimension table of open guiding eyes

Typ	d	L	L1	D
SH1	M8	70	25	20
SH3	M10	120	55	25
SH6	M12	180	60	25

Open guiding eye

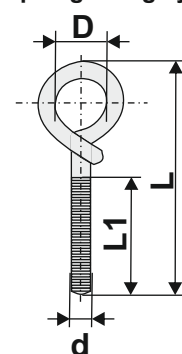

Closed guiding eye

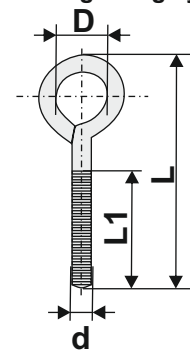

The catalogue has only those selected important parameters for your final decision. For project designs always ask for the user's guide for this product and any engineering consultation about possible uses.